



Victoria Street



£650 PCM

56 Merrial Street
Newcastle under Lyme
ST5 2AW
01782 625734



148 Victoria Street ST4 6HD

Nestled in the heart of Hartshill, this charming two-bedroom house on Victoria Street offers a delightful blend of comfort and convenience. Ideal for first-time renters or small families, the property boasts a well-designed layout and a large garage to the rear ideal for a home Gym or studio.

Upon entering, you are greeted by a lovely lounge which then moves through to a modern kitchen with space to have a breakfast table. Note: No appliances included.

The two bedrooms are generously sized, offering a peaceful retreat for rest and relaxation. The bathroom is on the ground floor and is modern and well-appointed.

This property benefits from excellent local amenities, including shops, schools, and parks, all within easy reach. The area is well-connected by public transport, making it convenient for commuting to nearby towns and cities.

£650 PCM





GROUND FLOOR

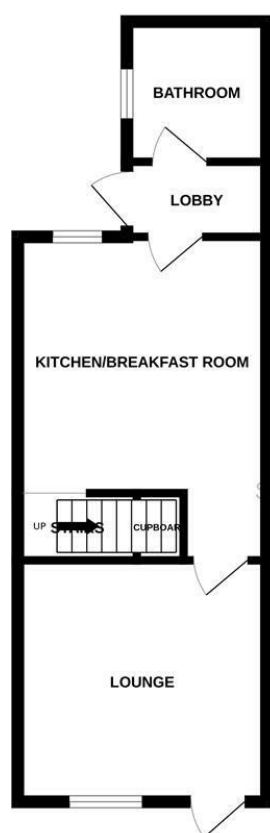

1ST FLOOR

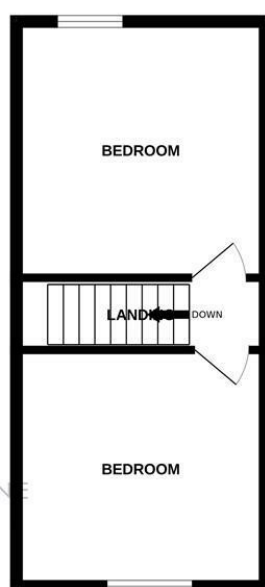

Whilst every attempt has been made to ensure the accuracy of the floorplan contained here, measurements of doors, windows, rooms and any other items are approximate and no responsibility is taken for any error, omission or mis-statement. This plan is for illustrative purposes only and should be used as such by any prospective purchaser. The services, systems and appliances shown have not been tested and no guarantee as to their operability or efficiency can be given.
Made with Metriplex ©2025

Stephenson Browne Estate Agents

Newcastle
56 Merrial Street, Newcastle under Lyme
Staffordshire, ST5 2AJ
Tel: 01782 625734

Sandbach
38 High Street, Sandbach
Cheshire, CW11 1AN
Tel: 01270 763200

Alsager
13 Crewe Road, Alsager
Stoke on Trent, ST7 2EW
Tel: 01270 883130

NOT TO SCALE These floor plans are given as a guide only. Full completed measurements and details should be verified by any intending purchasers legal representative.

NOTICE: Stephenson Browne for themselves and for the vendors or lessors of this property whose agents they are give notice that: (1) the particulars are set out as a general guideline only for the guidance of intending purchasers or lessees, and do not constitute, nor constitute part of, an offer or contract; (2) all descriptions, dimensions, references to condition and necessary permissions for use and occupation, and other details are given in good faith and are believed to be correct but any intending purchasers or tenants should not rely on them as statements or representations of fact but must satisfy themselves by inspection or otherwise as to the correctness of each theme; (3) no person in the employment of Stephenson Browne has any authority to make representation or warranty whatever in relation to this property. (4) fixtures & fittings are subject to a formal list supplied by the vendors solicitors.